



Department of Property & Procurement

Government of the United States Virgin Islands

3274 ESTATE RICHMOND, CHRISTIANSTED, U. S. VIRGIN ISLANDS 00820

8201 SUB BASE, 3RD FLOOR, ST. THOMAS, U. S. VIRGIN ISLANDS 00802

ST. CROIX MAIN OFFICE: 340.773.1561 | ST. THOMAS MAIN OFFICE: 340.774.0828

ST. CROIX FAX: 340.773.0986 | ST. THOMAS FAX: 340.774.9587

[HTTP://DPP.VI.GOV](http://DPP.VI.GOV)



July 14, 2020

AMENDMENT #1- IFB041DOET20 (C)– Qualified contractors to furnish all labor, tools, equipment, and supplies necessary for the **Construction of the Roof at the Charlotte Amalie High School, Buildings 29 and 30 on the island of St. Thomas, Virgin Islands.**

Questions and Answers

1. Question: “There are three (3) elements to eligibility for award: (a) responsiveness to the bid; (b) responsibility of the bidder and (c) price, "quality offered, delivery terms and service reputation." Are they given equal weight in decision to award?

Response: They do not give equal weight in the decision to award. The bid package submitted first has to (a) first be responsive to the bid requirement per the instructions in the Invitation for Bids to move further with the review of (b) and (c).

2. Question: Where can we get a copy of the following - SECTIONS 242-1 THROUGH 242-108, OF THE VIRGIN ISLANDS RULES AND REGULATIONS, PUBLISHED DECEMBER 1974 GOVERNING GENERAL CONDITIONS FOR CONTRACTING FOR PUBLIC WORKS PROJECT.

Response: A copy of this request can be found on the Department of Property and Procurement website under the DPP Rules and Regulation document.

3. Question: Will the Contract contain a Waiver of Consequential Damages?

Response: No.

4. Question: Does this project contain Consequential Damages

Response: The answer to this question cannot be determined at this time.

5. Question: What is the estimated contract award date?

Response: The contract award date is unknown. The Notice of Award will be upon the approval of the Commissioner of the Department of Property and Procurement.

6. Question: What is the estimated project start date?

Response: The Department anticipates a contract start of two weeks following contract execution by the Governor of the Virgin Islands

7. Question: Line Item #1.05- Provide quantity of steel column bases to be repaired.

Response: As per Section2: General Bidder's Instructions and Requirements states,

1. The selected licensed General Contractor (hereafter, "Contractor") shall be responsible for thoroughly inspecting all relevant existing conditions associated with this IFB. It is the contractor's responsibility to establish exact quantities and existing circumstances based upon the documents, instructions issued herein, and his site visits.

2. Question: Line Item #2.01- Provide a damage inventory list of electrical devices: panels, conduits, fixtures, junction boxes, re wire and all other electrical damages.

Response: As per Section2: General Bidder's Instructions and Requirements states,

1. The selected licensed General Contractor (hereafter, "Contractor") shall be responsible for thoroughly inspecting all relevant existing conditions associated with this IFB. It is the contractor's responsibility to establish exact quantities and existing circumstances based upon the documents, instructions issued herein, and his site visits.

3. Question: Line Item #3.01- Provide color codes to match existing

Response: The Department of Education shall Provide said color code to match existing paint upon selection of the qualified bidder. If a color code list cannot be provided by DOE, the contractor shall use the existing paint color as a sample to match existing paint.

4. Question: Line Item #6.02- provide concrete curb dimensions & access door specs

Response: The access hatch can be constructed of ¼" minimum thickness aluminum /steel plate or concrete. The contractor shall field verify all other dimensions.

5. Question: Line Item #8.02- Provide a damage inventory list of electrical devices: panels, conduits, fixtures, junction boxes, re wire and all other electrical damages.

Response: As per Section 2: General Bidder's Instructions and Requirements states,

1. The selected licensed General Contractor (hereafter, "Contractor") shall be responsible for thoroughly inspecting all relevant existing conditions associated with this IFB. It is the contractor's responsibility to establish exact quantities and existing circumstances based upon the documents, instructions issued herein and his site visits.

6. Question: Line Item #11.05- Provide a damage inventory list of electrical devices: panels, conduits, fixtures, junction boxes, re wire and all other electrical damages.

Response: As per Section2: General Bidder's Instructions and Requirements states,

1. The selected licensed General Contractor (hereafter, "Contractor") shall be responsible for thoroughly inspecting all relevant existing conditions associated with this IFB. It is the contractor's responsibility to establish exact quantities and existing circumstances based upon the documents, instructions issued herein and his site visits.

7. Question: Line Item #12.01- Provide a damage inventory list of electrical devices: panels, conduits, fixtures, junction boxes, re wire and all other electrical damages.

Response: As per Section2: General Bidder's Instructions and Requirements states,

1. The selected licensed General Contractor (hereafter, "Contractor") shall be responsible for thoroughly inspecting all relevant existing conditions associated with this IFB. It is the contractor's responsibility to establish exact quantities and existing circumstances based upon the documents, instructions issued herein and his site visits.

8. Question: Line Item #13.05- Provide Attachment 3 Sheet A- 2

Response: Please see attached.

9. Question: Line Item #13.06- Provide a damage inventory list of electrical devices: panels, conduits, fixtures, junction boxes, re wire and all other electrical damages.

Response: As per Section2: General Bidder's Instructions and Requirements states,

1. The selected licensed General Contractor (hereafter, "Contractor") shall be responsible for thoroughly inspecting all relevant existing conditions associated with this IFB. It is the contractor's responsibility to establish exact quantities and existing circumstances based upon the documents, instructions issued herein and his site visits.

10. Question: Line Item #13.07- Provide Attachment 3 Sheet A- 2

Response: See attached.

11. Question: Line Item #13.08- Provide Attachment 3 Sheet A-2

Response: See attached.

12. Question: Line Item #13.11- Provide Door & Hardware specs

**Response: Galvanized finish G90 electroplated metal for exterior doors
Galvanized finish & G60 electroplated metal for interior doors, Provide
door hardware by Stanley or approved equal**

Hinges: Stanley FBB Series

Door Closer: Stanley D-3550 series

Door Locksets: Stanley QCL 100 series

Deadbolt: Stanley QDB series

Panic Bar: Stanley QED 200 series

**Note: Locks shall be keyed as per DOE instructions; door hardware shall be
stainless steel or as per DOE recommendations.**

13. Question: Line Item #14.08- Provide reference drawings

Response: See attached.

14. Question: Line Item #14.09- Provide details for Ductwork and gypsum wall
(Dimensions)

**Response: The duct size shall be based on Vent manufacturer's
specifications. The contractor is responsible for means and methods in
enclosing said duct with type X gypsum wall board and metal framing
enclosure to conceal duct work. Note ductwork can be exposed if rigid metal
duct is used.**

15. Question: Line Item #14.11- Provide room dimension and equipment
requirements for qualifications.

**Response: As per Section2: General Bidder's Instructions and
Requirements states,**

**1. The selected licensed General Contractor (hereafter, "Contractor")
shall be responsible for thoroughly inspecting all relevant existing conditions
associated with this IFB. It is the contractor's responsibility to establish
exact quantities and existing circumstances based upon the documents,
instructions issued herein and his site visits.**

**Contractor shall engage the services of a certified air condition provider for
sizing the A/C unit.**

16. Question: Line Item #14.12- Provide Door & Hardware specs

**Response: Galvanized finish G90 electroplated metal for exterior doors
Galvanized finish & G60 electroplated metal for interior doors, Provide
door hardware by Stanley or approved equal**

Hinges: Stanley FBB Series

Door Closer: Stanley D-3550 series

Door Locksets: Stanley QCL 100 series

Deadbolt: Stanley QDB series

Panic Bar: Stanley QED 200 series

Note: Locks shall be keyed as per DOE instructions; door hardware shall be stainless steel or as per DOE recommendations.

17. Question: Line Item #15.02- Provide APPROVED PLANS

Response: The contractor shall obtain a copy of the approved plans under Invitation for Bids on the DPP website.

18. Question: Line Item #15.05- provide room dimension and equipment requirements for qualifications.

Response: As per Section2: General Bidder's Instructions and Requirements states,

1. The selected licensed General Contractor (hereafter, "Contractor") shall be responsible for thoroughly inspecting all relevant existing conditions associated with this IFB. It is the contractor's responsibility to establish exact quantities and existing circumstances based upon the documents, instructions issued herein and his site visits.

Contractor shall engage the services of a certified air condition provider for sizing the A/C unit.

19. Question: Line Item #15.06- Provide equipment electrical requirement and panel distance and capacity to qualify

Response: As per Section2: General Bidder's Instructions and Requirements states,

1. The selected licensed General Contractor (hereafter, "Contractor") shall be responsible for thoroughly inspecting all relevant existing conditions associated with this IFB. It is the contractor's responsibility to establish exact quantities and existing circumstances based upon the documents, instructions issued herein and his site visits.

20. Question: Line Item #15.07- Provide dimensions (distance of connection) & Equipment requirements

Response: As per Section2: General Bidder's Instructions and Requirements states,

1. The selected licensed General Contractor (hereafter, "Contractor") shall be responsible for thoroughly inspecting all relevant existing conditions associated with this IFB. It is the contractor's responsibility to establish exact quantities and existing circumstances based upon the documents, instructions issued herein and his site visits.

21. Question: Line Item #17.08- Provide Attachment 4-Typical Spall Repair Details

Response: See attached

22. Question: Line Item #18.01- Provide area of protection required

Response: The contractor shall protect all equipment, desk, chairs etc. in building 29 & 30 before power washing the roof. In other words, protect

items on the interior from getting wet incase water from power washing infiltrates the building.

23. Question: Is mold remediation is excluded from project scope?

Response: This IFB and Scope of Work does not include, require or request a cost for Mold Remediation.

24. Question: Is lead and asbestos inspection and removal is excluded from project scope?

Response: This IFB and Scope of Work does not include, require or request a cost for Lead and Asbestos Inspection or Removal.

25. Question: Electrical inspection was performed as part of damage assessment?

Response: This question is unclear.

26. Question: When school was built (year)?

Response: This school was originally built in 1955. However, the buildings in this IFB was built in the early to mid to late 1970s.

27. Question: Damage inventory for furniture removal, storage or disposal is excluded?

Response: This question is unclear.

28. Question: Clean and sanitize is excluded for all classrooms?

Response: Contractor shall Clean all spaces listed in the scope of work from construction debris and dust, such that instruction can take place upon completion of the project as a whole.

ALL OTHER TERMS AND CONDITIONS REMAIN UNCHANGED.

BIDDERS MUST ACKNOWLEDGE RECEIPT OF THIS AMENDMENT WITH THEIR BID PROPOSAL.

Deferred Maintenance Repair Program

DMRP Program Approved DOI-IOA ABC Initiative Work Plan

NO.	DATE	REVISIONS	REMARKS

C.A.H.S: Roof Repair- Plumbing Shop Bldg.
CHARLOTTE AMALIE HIGH SCHOOL
St. Thomas, USVI

DRAWN BY:
 CHECKED BY:
 APPROVED BY:
 CONTRACT NO.:
 PROJECT NO.:
 DATE:

SHEET NO.: **A1**

SHEET NO. OF SHEETS

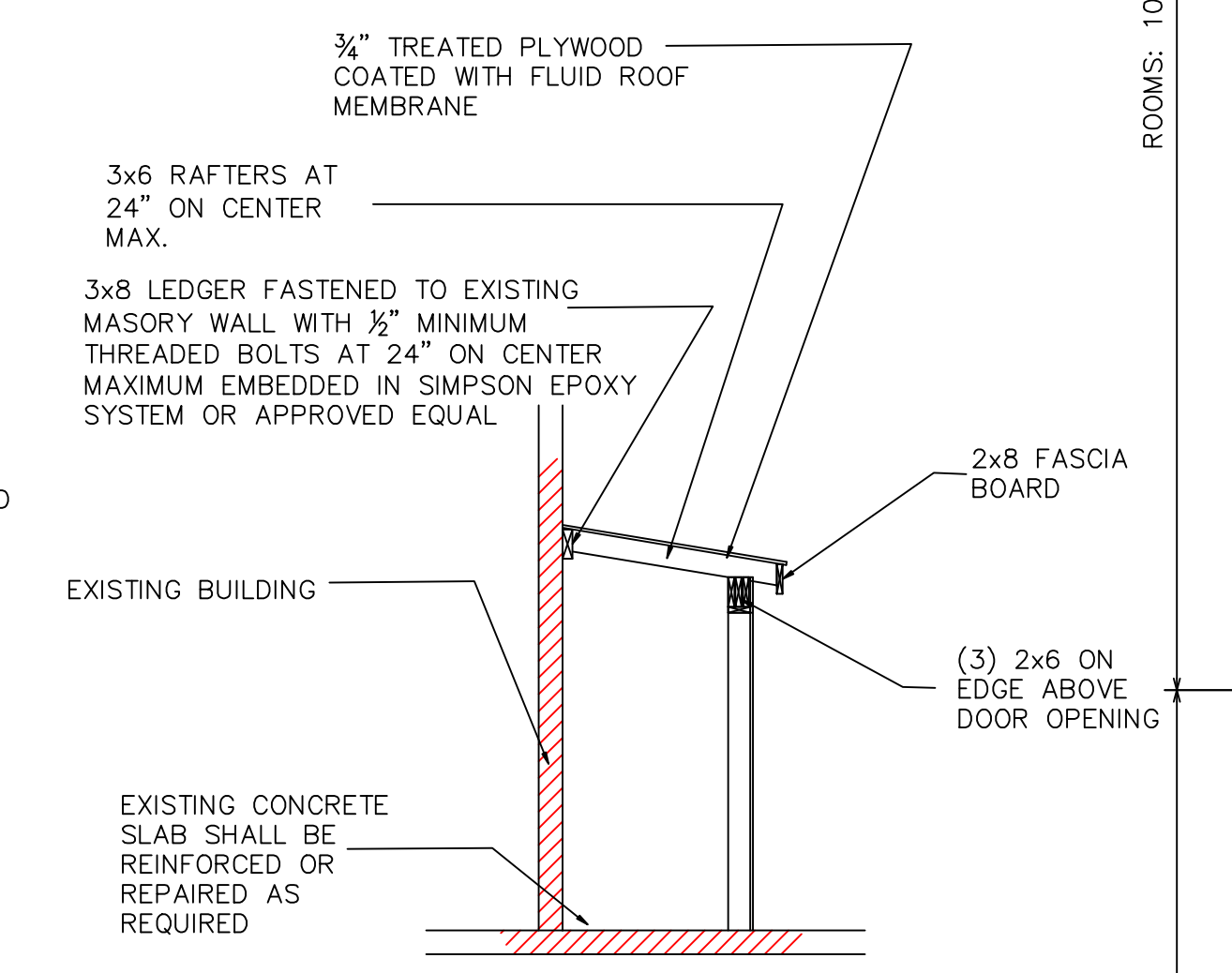
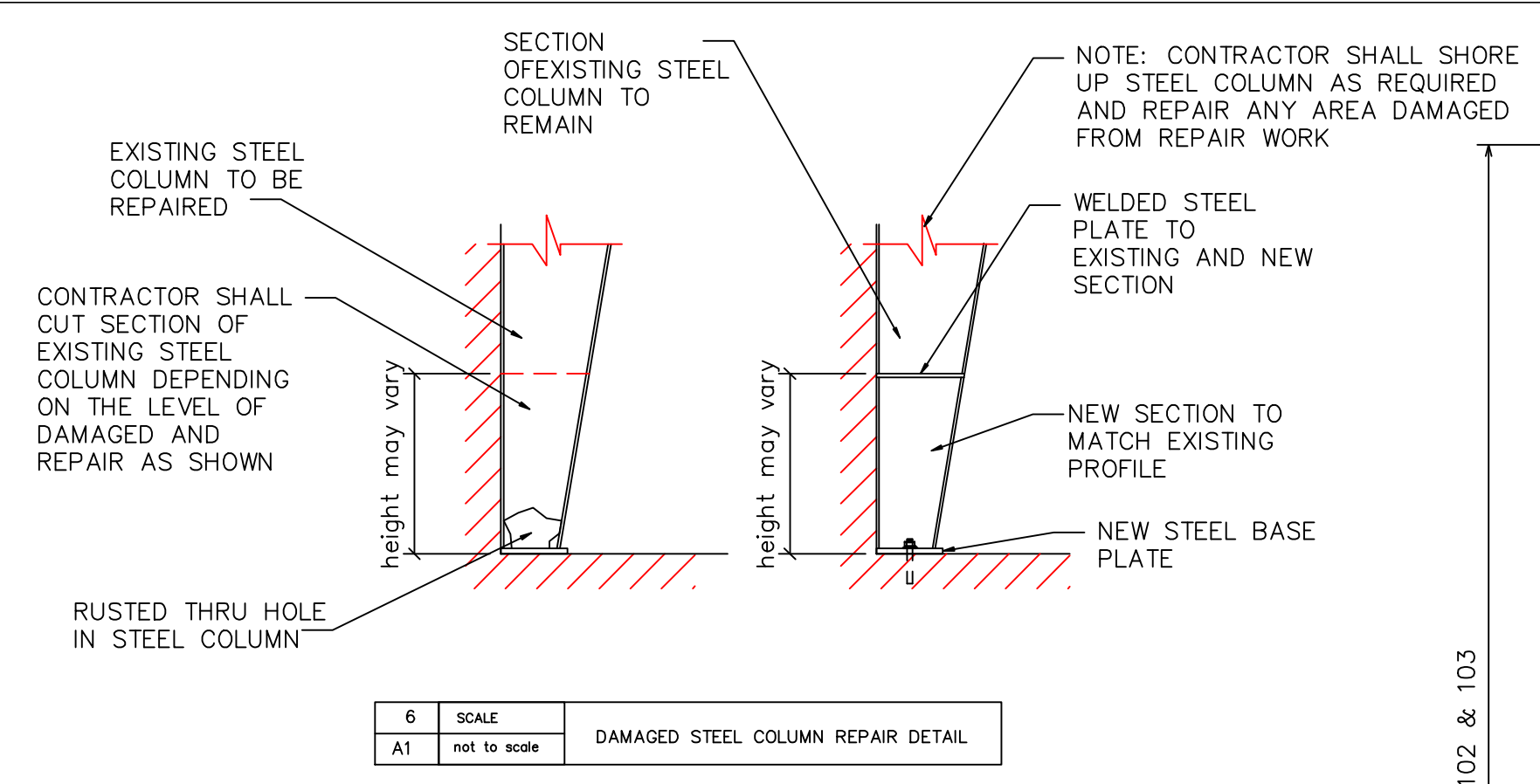
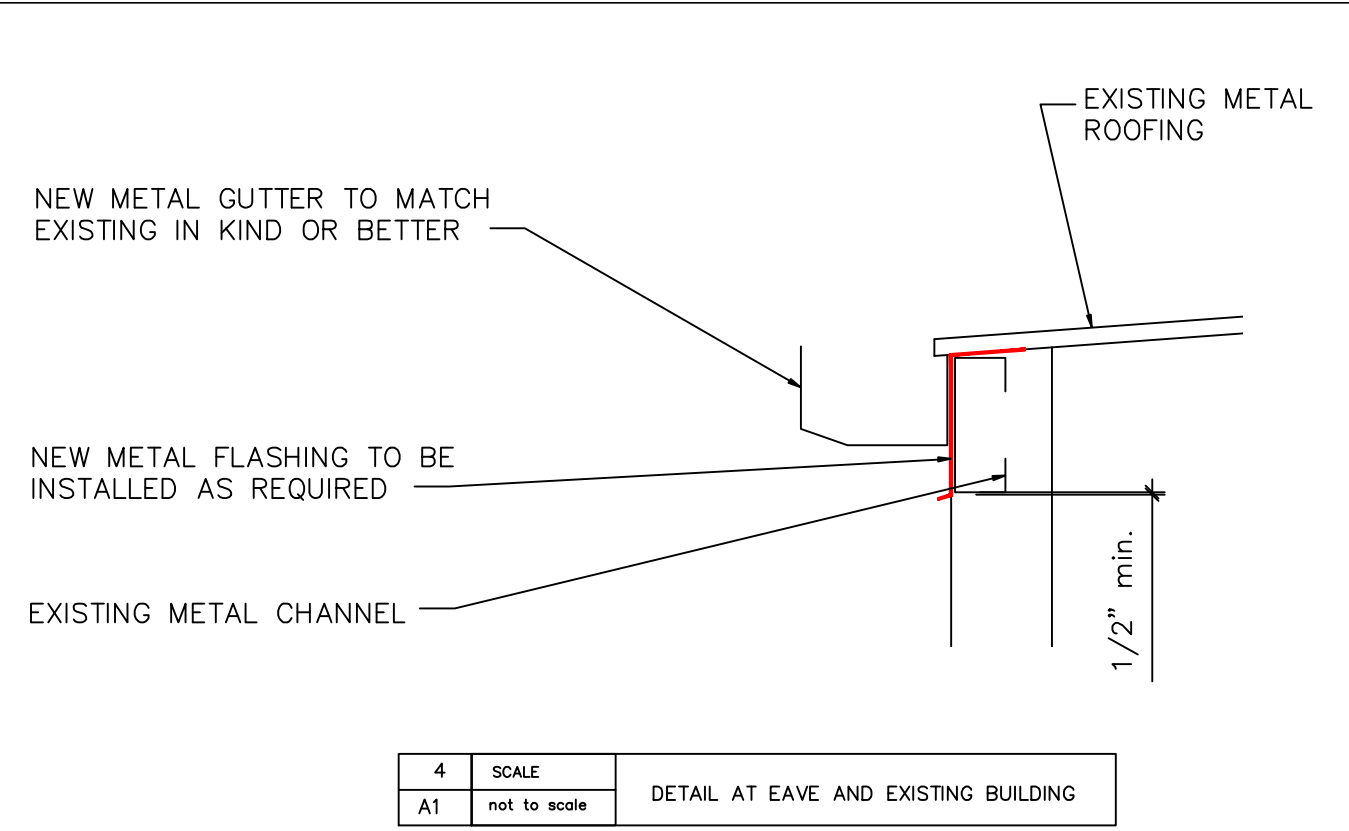

Proposed Shed For Electrical Components

SCALE: 1/4" = 1'-0"

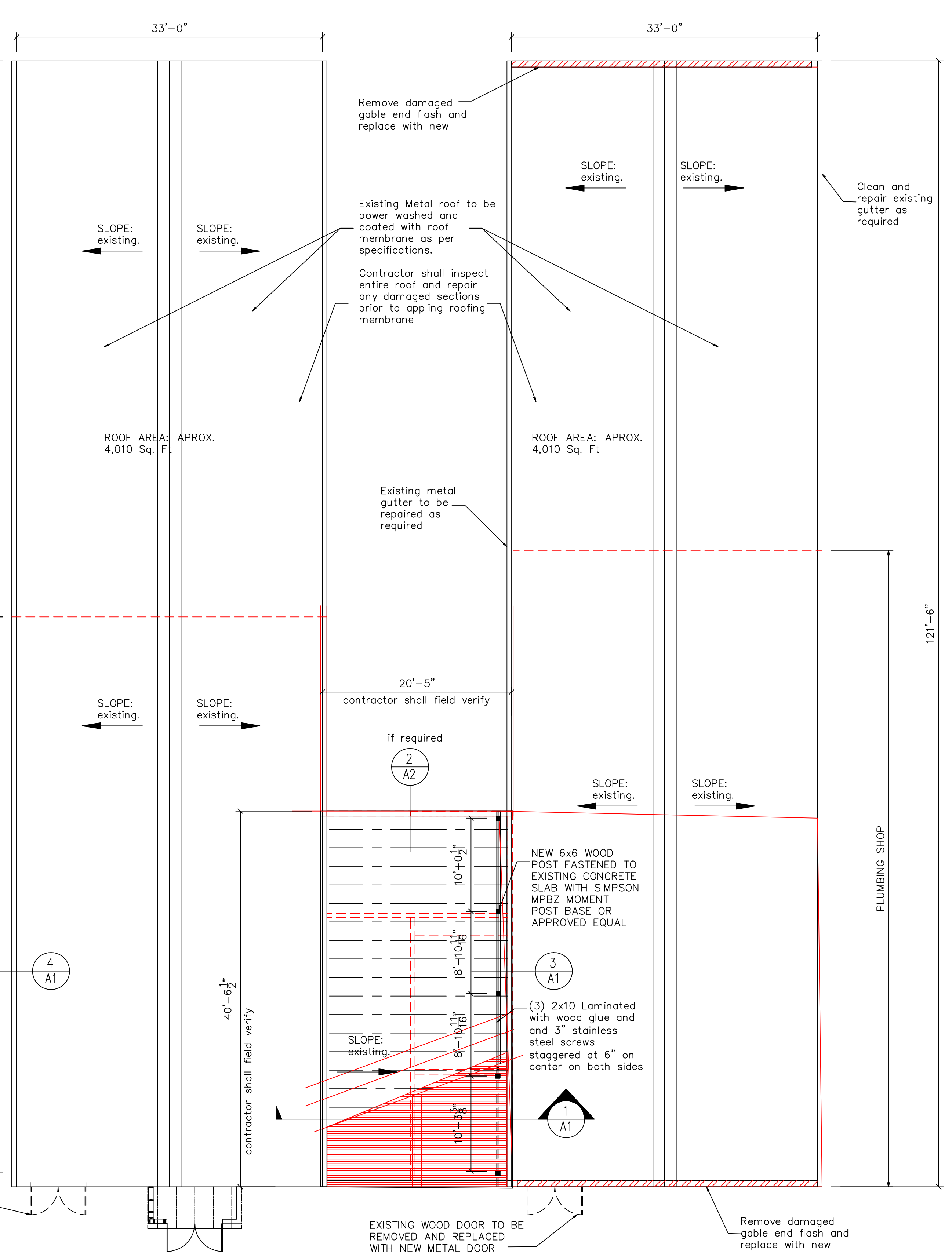
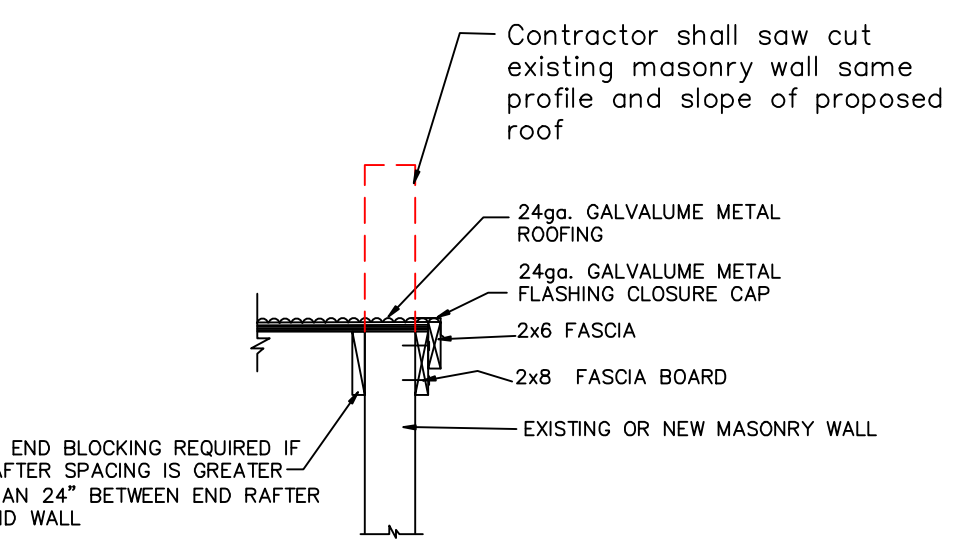

Proposed Roof Repair at Plumbing Shop Building

SCALE: 1/8" = 1'-0"

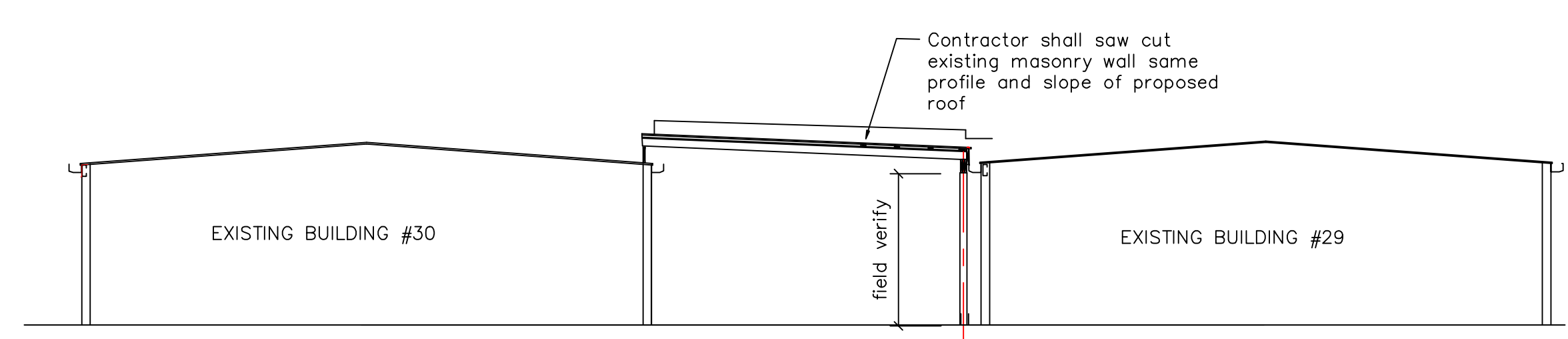

NOTE: Contractor shall field verify all dimensions elevation, quantity and conditions prior to final bid submission

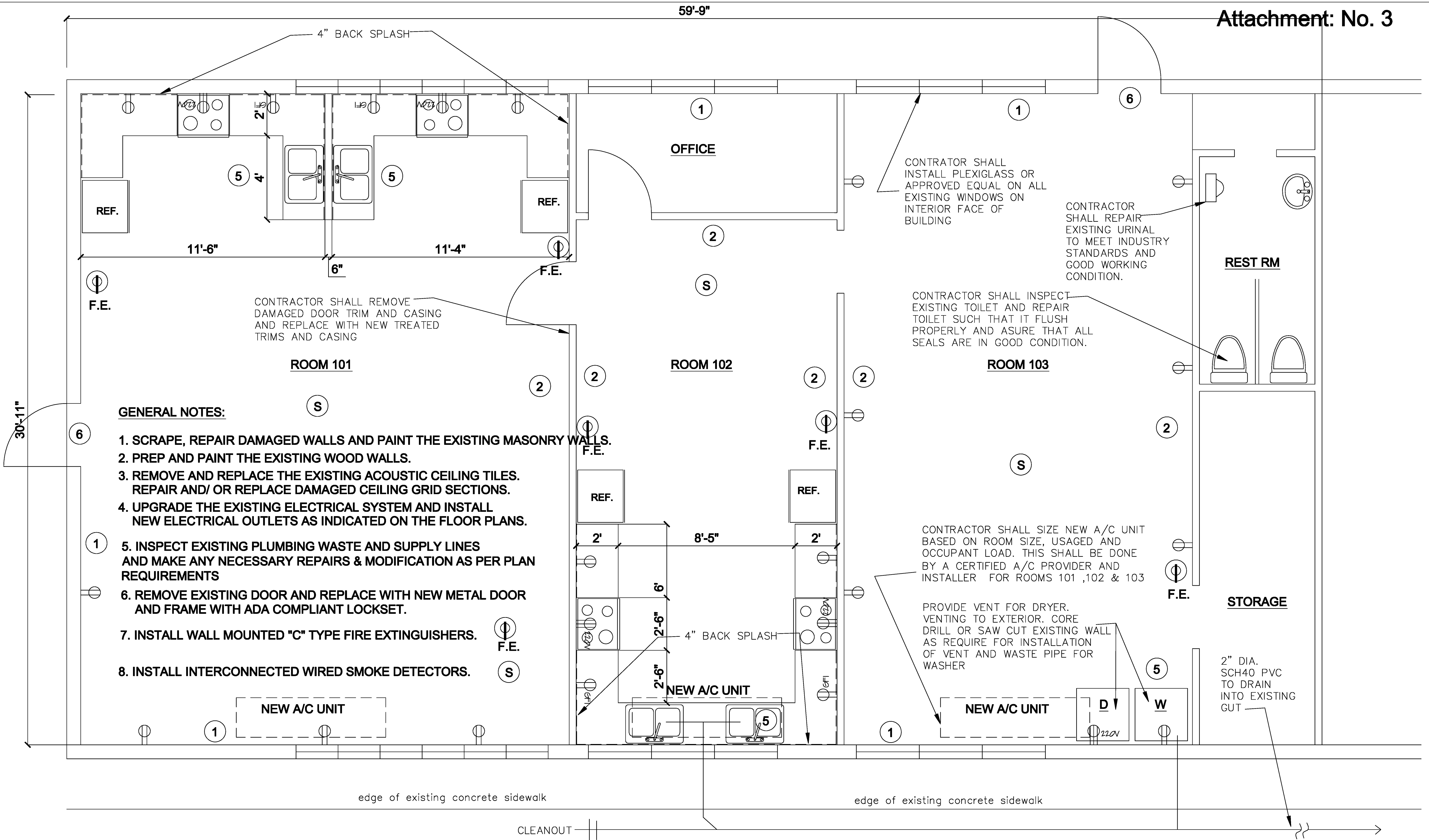

GENERAL NOTES:

1. SCRAPE, REPAIR DAMAGED WALLS AND PAINT THE EXISTING MASONRY WALLS.
2. PREP AND PAINT THE EXISTING WOOD WALLS.
3. REMOVE AND REPLACE THE EXISTING ACOUSTIC CEILING TILES. REPAIR AND/ OR REPLACE DAMAGED CEILING GRID SECTIONS.
4. UPGRADE THE EXISTING ELECTRICAL SYSTEM AND INSTALL NEW ELECTRICAL OUTLETS AS INDICATED ON THE FLOOR PLANS.
5. INSPECT EXISTING PLUMBING WASTE AND SUPPLY LINES AND MAKE ANY NECESSARY REPAIRS & MODIFICATION AS PER PLAN REQUIREMENTS
6. REMOVE EXISTING DOOR AND REPLACE WITH NEW METAL DOOR AND FRAME WITH ADA COMPLIANT LOCKSET.
7. INSTALL WALL MOUNTED "C" TYPE FIRE EXTINGUISHERS.
8. INSTALL INTERCONNECTED WIRED SMOKE DETECTORS.

Partial plan on bldg. 30

NOTE: THESE NOTES AND DETAILS ARE A GENERAL RECOMMENDATION ONLY. A LICENSED STRUCTURAL ENGINEER SHALL VERIFY ALL EXISTING CONDITIONS TO DETERMINE THEIR APPLICABILITY.

CONCRETE REPAIR NOTES:

- EXCAVATE ALL LOOSE FRACTURED CONCRETE AROUND SPALL. IN GENERAL, EXTEND LIMITS OF EXCAVATION UNTIL SOUND CONCRETE IS ENCOUNTERED OR AS SHOWN ON THE DRAWINGS. LIMIT CHIPPING GUN TO 15 LB.
- CLEAN ALL EXISTING REBAR OF ALL LOOSE RUST BY SANDBLAST OR NEEDLE GUN.
- ROUGHEN SURFACE TO 1/4" AMPLITUDE AT ALL INTERFACE CONTACT WITH EXISTING CONCRETE SUBSTRATE. PROVIDE UNDERCUT AT PERIMETER OF CONCRETE PATCH AS SHOWN ON DETAILS.
- CLEAN ALL EXCAVATED CONCRETE SURFACES OF DEBRIS, DUST, GREASE, OIL, ETC.
- IN GENERAL, THE FOLLOWING APPLIES TO REPLACEMENT/SUPPLEMENT OF CORRODED REBAR:
 - IF CROSS-SECTIONAL LOSS OF BAR IS LESS THAN 20% AFTER REMOVING ALL CORROSION PRODUCT, THE BAR DOES NOT REQUIRE REPLACEMENT/SUPPLEMENT.
 - IF CROSS-SECTIONAL LOSS OF BAR IS GREATER THAN 20% AFTER REMOVING ALL CORROSION PRODUCT, REPLACE OR SUPPLEMENT WITH SPLICED BARS PER DETAIL 1 THIS SHEET.
- ALL REPLACEMENT REINFORCING STEEL SHALL CONFORM TO ASTM A706 GRADE 60 UNLESS OTHERWISE NOTED.
- WHERE REINFORCING STEEL IS TO BE ADDED, IT SHALL BE LAP SPICED FOR A LENGTH OF 48 BAR DIAMETERS. IN LIEU OF LAPPED REBAR, NEW REINFORCING MAY BE WELDED TO EXISTING REINFORCING PER DETAIL 1F THIS SHEET.
- PRIOR TO PLACEMENT OF PATCH MATERIAL, THE EXPOSED CONCRETE SHALL BE SATURATED SURFACE DRY WITH NO WATER ACCUMULATION.
- REPAIR MATERIALS SHALL BE APPLIED TO FILL VOIDS. FOR PATCH DEPTHS IN EXCESS OF ONE INCH, CONCRETE PATCH SHALL CONTAIN 3/8" PEA GRAVEL AGGREGATE.
- FOR DEEP OVERHEAD AND VERTICAL PATCHES, CEMENTITIOUS MATERIAL (PER ITEM "B" IN THE TABLE OF ACCEPTABLE CONCRETE REPAIR PRODUCTS) MAY BE USED IF APPLIED IN LIFTS. THICKNESS OF LIFTS AND TOTAL THICKNESS OF PATCH SHALL NOT EXCEED THE MAXIMUM THICKNESS RECOMMENDED BY THE MANUFACTURER. A CLEAN, ROUGHEN SURFACE SHALL BE MAINTAINED WITH AN APPROPRIATE SETTING TIME, PER MANUFACTURER'S INSTRUCTIONS, FOR PLACEMENT BETWEEN LIFTS. ALTERNATIVELY, THE PATCH SHALL BE FORMED AND CONCRETE PER ITEMS "C" AND "D" ON THE TABLE OF ACCEPTABLE CONCRETE REPAIR PRODUCTS SHALL BE USED. WHEN FORMED, THE CONCRETE SHALL BE EXTERNALLY AND/OR INTERNALLY VIBRATED AS IT IS PLACED IN THE FORMS TO ACHIEVE THE PROPER CONSOLIDATION TO FILL ALL CORNERS OF THE FORMS; ALLOWING SUFFICIENT SPACE AT THE TOP OF THE FORMED AREA TO PROPERLY PLACE AND CONSOLIDATE THE CONCRETE.
- FOLLOWING THE INITIAL SET OF THE CONCRETE AT FORMED AREAS, THE SPACE AT THE TOP OF THE PATCH AREA SHALL BE FILLED WITH PATCHING MORTAR.
- THE SURFACE FINISH SHALL MATCH ADJACENT CONDITIONS.
- FORMS SHALL BE REMOVED AFTER FIVE DAYS OF CURING. PATCHES SHALL BE INSPECTED FOR IMPROPER CONSOLIDATION OR CRACKING AROUND THE PERIMETER OR IN THE PATCH. IF THESE CONDITIONS EXIST, NOTIFY THE CONTRACTING OFFICER FOR POSSIBLE REMEDIAL ACTION.
- MINIMUM CONCRETE COVER TO REINFORCING STEEL FOR "PATCHES," REPAIRS, ETC., SHALL BE AT LEAST 2" FOR CONCRETE EXPOSED TO WEATHER AND 1 1/2" FOR CONCRETE NOT EXPOSED TO WEATHER.
- CONCRETE REPAIR AREAS SHALL BE ALLOWED TO CURE A MINIMUM OF 14 DAYS PRIOR TO SURFACE PRIMING AND PAINTING.

ACCEPTABLE CONCRETE REPAIR PRODUCTS

PRODUCT DESCRIPTION	ACCEPTABLE ALTERNATIVE PRODUCTS
A. MATERIAL FOR MINOR PATCH REPAIRS	• SEE PROJECT SPECIFICATIONS
B. MATERIAL FOR INTERMEDIATE PATCH REPAIRS	• SEE PROJECT SPECIFICATIONS
C. STEEL ANCHORS	<ul style="list-style-type: none"> • 1/4" ZINC PLATED HILTI KWIK-CON II HEX HEAD SCREWS IN 1/4" DEEP HOLE DRILLED WITH MATCHING DRILL BIT • 1/4" CLIMASEAL REDHEAD TAPCON IN 1/4" DEEP HOLE DRILLED WITH MATCHING DRILL BIT • 1/4" SIMPSON TITEN HD MINI IN 1/4" DEEP HOLE DRILLED WITH MATCHING DRILL BIT
D. BONDING AGENT (REFER TO PATCH MATERIAL PRODUCT SPECS FOR COMPATIBILITY)	<ul style="list-style-type: none"> • SIKA ARMATEC 110 • THORO ACRYL 60 • QUIKCRETE BONDING ADHESIVE
E. EPOXY TO SET ANY DOWELS	<ul style="list-style-type: none"> • HILTI HIT-RE 500-SD EPOXY ADHESIVE (INTERIOR APPLICATIONS ONLY) • HILTI HIT-HY 150 ACRYLIC ADHESIVE • RED HEAD EPON C6 EPOXY ADHESIVE (INTERIOR APPLICATIONS ONLY) • RED HEAD EPON A7 ACRYLIC ADHESIVE • SIMPSON SET-XP EPOXY-TIE ADHESIVE (INTERIOR APPLICATIONS ONLY) • SIMPSON AT ACRYLIC-TIE ADHESIVE

U.S. DEPARTMENT OF THE INTERIOR
 OFFICE OF INSULAR AFFAIRS
INSULAR ABCs PHASE III
UNITED STATE VIRGIN ISLANDS

MARTIN & CHOCK
 CONSULTING STRUCTURAL ENGINEERS
 1132 Bishop Street Suite 1550 Honolulu, Hawaii 96813
 phone: (808) 521-4513 fax: (808) 531-4508
 www.martinchock.com

INVITATION FOR BID- Attachment #4

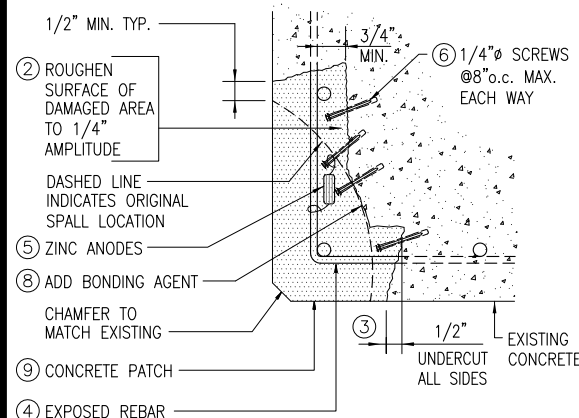

1A INTERMEDIATE PATCH REPAIR
 CORNER SPALL
 MIN. PATCH DEPTH = 1 1/2"
 MAX. PATCH DEPTH = AS REQUIRED

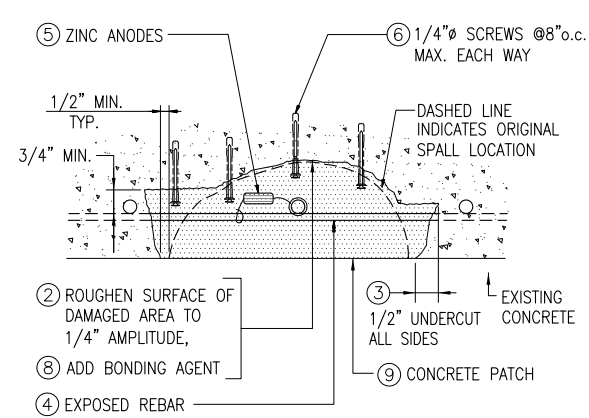

1B INTERMEDIATE PATCH REPAIR
 VERTICAL OR HORIZONTAL SPALL
 MIN. PATCH DEPTH = 1 1/2"
 MAX. PATCH DEPTH = AS REQUIRED

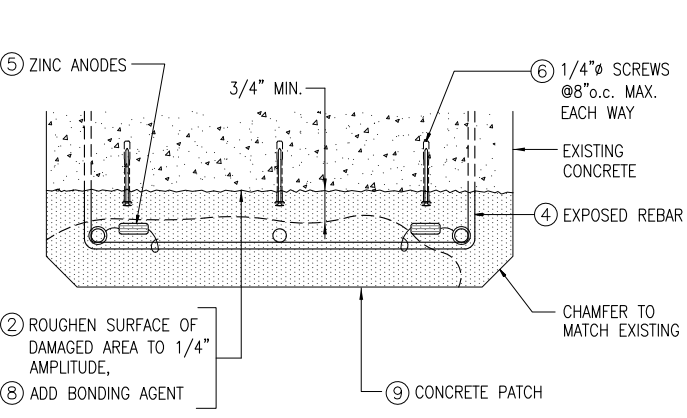

1C INTERMEDIATE PATCH REPAIR
 SPALL FULL WIDTH OF MEMBER
 MIN. PATCH DEPTH = 1 1/2"
 MAX. PATCH DEPTH = AS REQUIRED

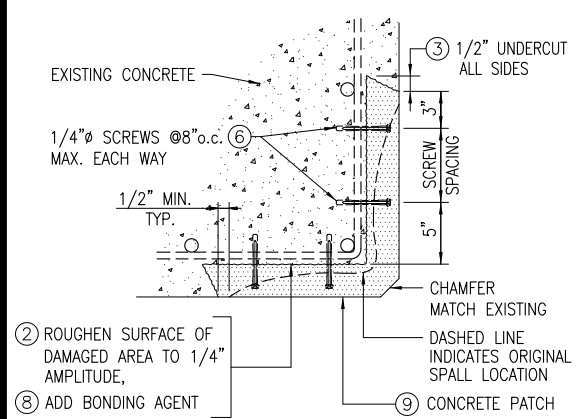

1D MINOR PATCH REPAIR
 CORNER SPALL
 MIN. PATCH DEPTH = 1"
 MAX. PATCH DEPTH = 1 1/2"
 MAX. EXPOSED REBAR LENGTH = 4"

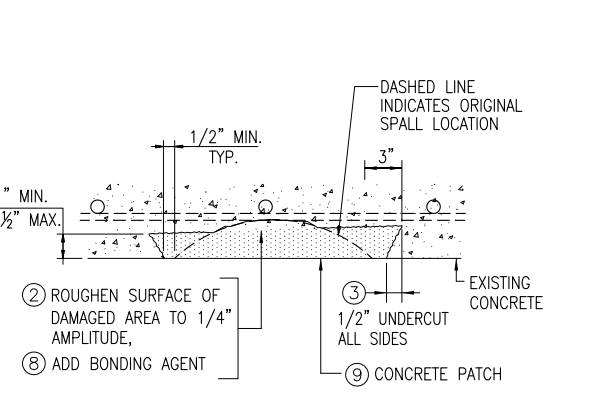

1E MINOR PATCH REPAIR
 VERTICAL OR HORIZONTAL SPALL
 MIN. PATCH DEPTH = 1"
 MAX. PATCH DEPTH = 1 1/2"
 MAX. EXPOSED REBAR LENGTH = 4"

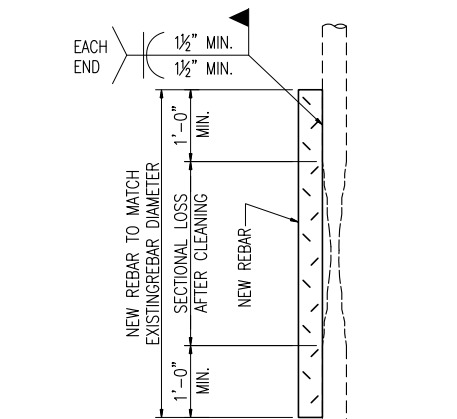

1F REINFORCING REPLACEMENT

REPAIR PROCEDURE

- CHIP OUT ALL LOOSE AND FRACTURED CONCRETE AROUND SPALL. EXTEND LIMITS OF EXCAVATION UNTIL SOUND CONCRETE IS ENCOUNTERED.
- ROUGHEN SURFACE TO 1/4" MINIMUM AMPLITUDE.
- CREATE 1/2" UNDERCUTS CUT AT PERIMETER.
- CLEAN ALL EXPOSED REBAR TO BRIGHT STEEL CONDITION. REPLACE CORRODED BARS WHICH HAVE LOST MORE THAN 20% OF CROSS-SECTION AND/OR AS DIRECTED BY THE ENGINEER (SEE DETAIL 1 THIS SHEET).
- INSTALL SACRIFICIAL ZINC ANODES WHERE REQUIRED (SEE DETAIL 2 THIS SHEET FOR INSTALLATION).
- INSTALL 1/4" SCREWS @8" o.c. MAX. EACH WAY. SEE ITEM "F" ON TABLE OF ACCEPTABLE CONCRETE REPAIR PRODUCTS ON THIS SHEET. PROVIDE 1 1/4" MIN. EMBEDMENT INTO SOUND CONCRETE. PROVIDE 3/4" MIN. CLEAR COVER TO HEAD OF SCREW AFTER PATCH INSTALLATION.
- PROVIDE SHADE ABOVE WORK AREA OF PATCHES IF CONCRETE MEMBER IS EXPOSED TO DIRECT SUNLIGHT DURING CURING.

- APPLY BONDING AGENT TO CONCRETE SURFACE. SEE ITEM "G" ON THE TABLE OF ACCEPTABLE CONCRETE REPAIR PRODUCTS ON THIS SHEET.
- INSTALL PATCH MATERIAL ACCORDING TO MANUFACTURER'S RECOMMENDATIONS. SEE ITEMS "A" THROUGH "D" ON THE TABLE OF ACCEPTABLE CONCRETE REPAIR PRODUCTS ON THIS SHEET.
- FINISH AND CURE AS REQUIRED.

REINFORCING REPLACEMENT NOTES:

- SEE CONCRETE REPAIR NOTES 2, 5, 6, & 7 FOR GENERAL REPLACEMENT/SUPPLEMENT OF (E) REINFORCING.
- WELDING OF REINFORCING STEEL SHALL BE IN ACCORDANCE WITH "STRUCTURAL WELDING CODE-REINFORCING STEEL" (AWS D1.4).
- REBAR FOR SPLICE SHALL BE ASTM A706, GRADE 60.
- PREHEAT BARS ACCORDING TO AWS D1.4 STANDARDS.

1 TYPICAL CONCRETE REPAIR DETAIL AT SLABS, BEAMS AND COLUMNS
 N.T.S.

DRAWING TITLE
TYPICAL CONCRETE AND MASONRY REPAIRS

NO.	DATE	REVISION

DATE FEB 3, 2017
 SHEET **S-1**
 1 OF 1